

Rigid Endoscope Fibre Light Cables

A Guide to Choosing & Ordering



Pride.Precision.Performance.

Offering a wide range of cable options, with thousands of combinations, including fibre bundle sizes, lengths, reinforcement, colours and connector tips, Bolton Surgical are a premier supplier of rigid endoscope fibre light cables. With many options to choose from, customers are sure to find the perfect cable combination.

www.boltons.co.uk

Our fibre light cables offer:

- Great value for money in comparison with other leading brands on the market
- Fast delivery, with most popular cable combinations held in stock
- A one year guarantee (Terms and Conditions apply)
- Universal range of fittings is available allowing 'mix and match' connectors
- Cables available with a choice of reinforcement options
- Ability to colour code by instrument set type or cable type
- Custom made light cables available to customers own specification

Key features:

- Compatible with all recommended commonly used neutral, up to 10.5pH, and enzymatic surgical cleaning fluids
- Will withstand repeated, routine autoclave sterilisation cycles at 134°C for 3mins with a 20 minute drying time
- High temperature compatible up to 300-watt Xenon
- Rated to the highest level of thermal resistance and tested to ensure the highest light output possible
- Medical grade silicone and stainless steel are used during the manufacturing process
- Latex Free

How to order

Please use this ordering guide to help create your perfect fibre light cable. Once you have the catalogue number for the product you require, you can request a quotation by contacting your area sales consultant, or our customer services team by emailing sales@boltons.co.uk, or by calling **0114 240 4400**.

Need assistance with choosing the right cable?

Our sales consultants have sample kits and can run through the different options with you, please contact us should you wish to utilise this service.

Can't find the connector you're looking for? Please ask us as we have other less common connectors available.

Ordering from outside of the United Kingdom?

Please contact your local agent or distributor, contact information for all our agents and distributors can be found by visiting our website at www.boltons.co.uk. Overseas customers can also contact our export department directly by emailing export@boltons.co.uk, or by calling us on **+44 (0)114 240 4400**.

After Sales Service

Once you have purchased your Bolton Surgical fibre light cable, we aim to ensure you achieve the maximum service life possible from your product. Our testing and repair service will test your cable at regular intervals to ensure maximum performance, offering repair or service exchange if appropriate.

The following downloads are available from our website by visiting www.boltons.co.uk

- A guide to choosing and ordering Rigid Endoscope Fibre Light Cables
- Technical data sheet - Cable Construction and Connector Specifications
- Certificate of Guarantee for Fibre Light Cables
- IFU's for Rigid Endoscope Fibre Light Cables
- Declaration of Conformity for Rigid Endoscope Fibre Light Cables

STEP 1 SELECT PROXIMAL (MACHINE) CONNECTOR

AC ACMI/CIRCON



WD WOLF/DYONICS

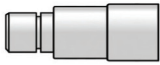

WL WOLF/LONG



O OLYMPUS/ACMI



S STORZ



P PILLING



U UNIVERSAL**



STEP 2 SELECT DISTAL (INSTRUMENT) CONNECTOR

WS WOLF SNAP ON

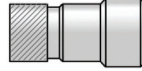

WC WOLF CLIP ON

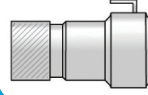

S STORZ

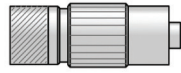

P PILLING

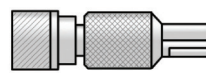

ACS ACMI/CIRCON SNAP ON

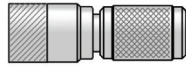

ACC ACMI/CIRCON CLIP ON

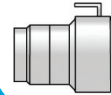

MO MINI OLYMPUS*



U UNIVERSAL**



* Available in bundle sizes 2.8 and 4.25mm and colours black, white, grey and pink only
 ** A screw adapter is necessary for this connector and must be ordered separately

STEP 3 SELECT FIBRE OPTIC BUNDLE SIZE

22



2.2mm

30



3.0mm

38



3.8mm

48



4.8mm

Mini-Olympus Distal Connector Only

28



2.8mm

425



4.25mm

STEP 4 SELECT FIBRE OPTIC CABLE LENGTH

6 6ft (180cm)

8 8ft (250cm)

10 10ft (300cm)

Custom lengths are also available

STEP 5 SELECT SHEATHING TYPE

0 Non-reinforced

6R 6" Reinforced Ends

FR Fully-Reinforced

STEP 6 SELECT SHEATHING COLOUR

CL Clear*



PK Pink



WH White



YL Yellow



RD Red



GR Green



GY Grey

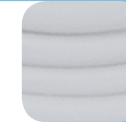

BK Black



*CL Clear sheathing is only available in non-reinforced sheathing type

BL Blue





T. +44 (0)114 240 4400
F. +44 (0)114 257 6555
E. enquiries@boltons.co.uk
@BoltonSurgical
www.boltons.co.uk



MD 500657